

#183490

# Incomplete house in Episkopi, Limassol

📍 Episkopi Lemesou, Limassol

€112,000

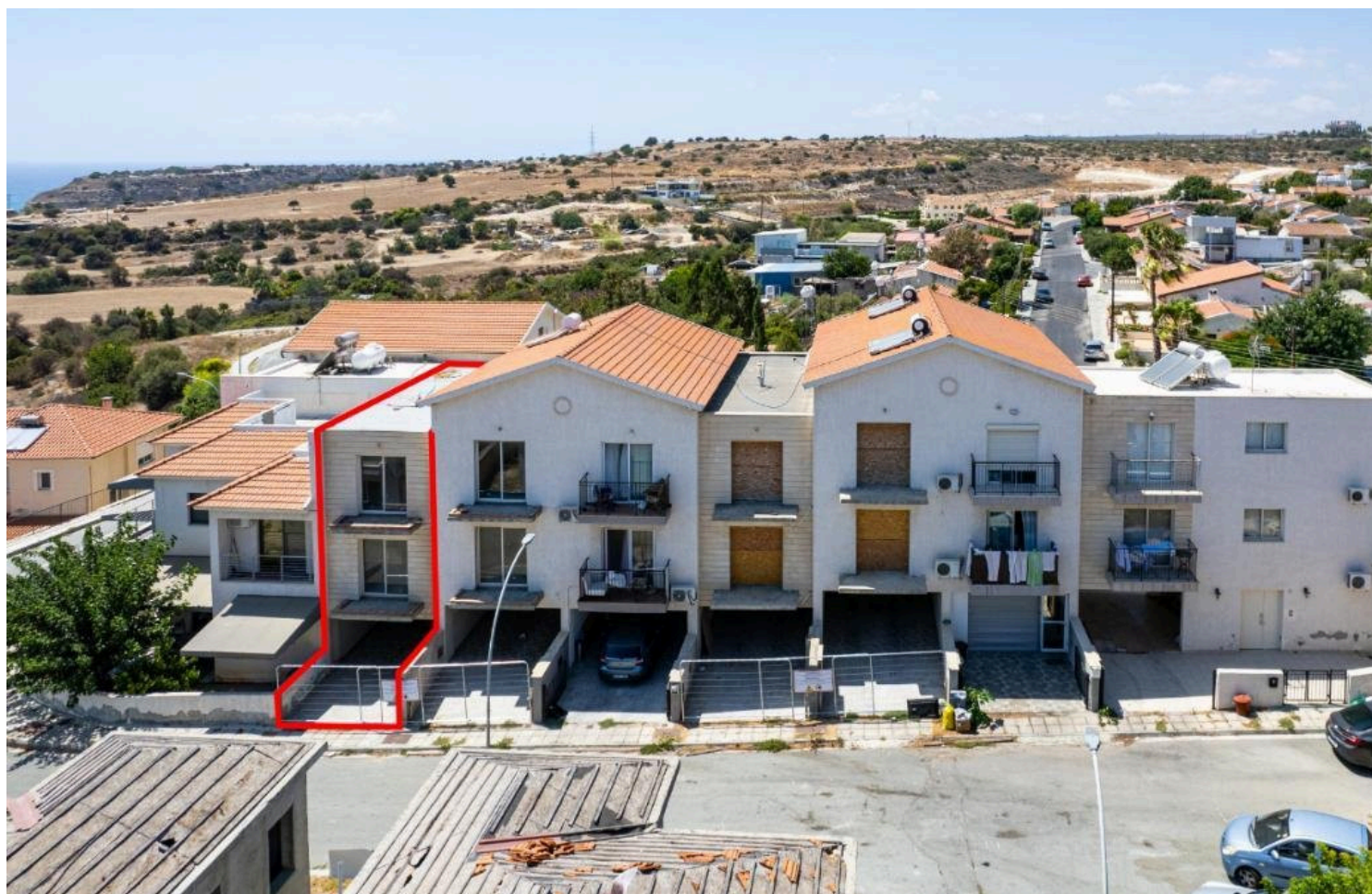

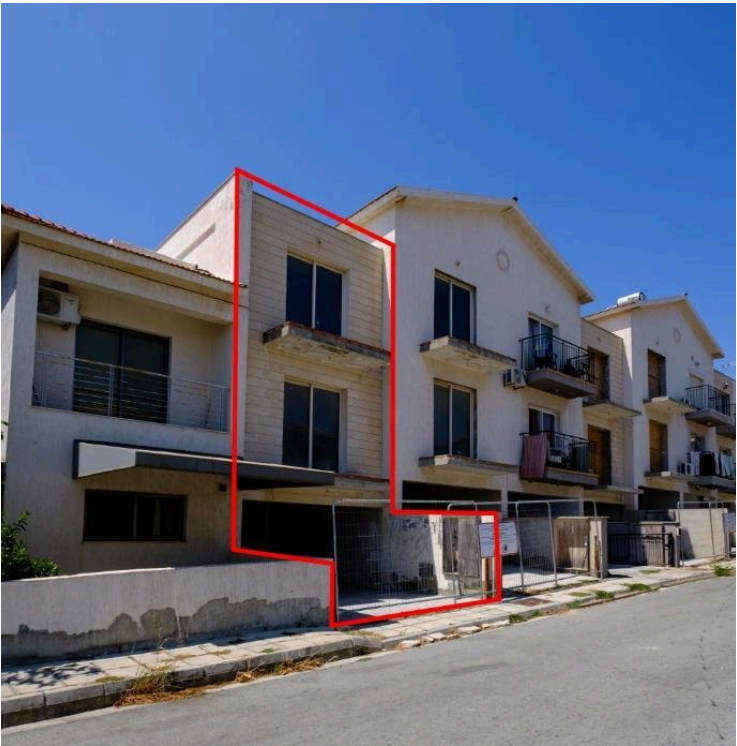

# Overview

## Specifications

Bedrooms

 2

Bathrooms

 1

Covered

 98 m<sup>2</sup>

Status

**Resale**

Year of construction

**2011**

## Description

The property is an incomplete house (no. 5) in Episkopi. It is located 110m from Episkopi Elementary School and 2,7km from the coastline. It is part of a residential complex consisting of eleven houses, parking spaces with exclusive right of use, private yards and commonly used areas.

The house is situated on the first floor. It has an internal area of 98sqm, covered verandas of 3sqm and uncovered verandas of 3sqm. The first floor consists of an open plan kitchen-living room, a guest's WC and a covered veranda. The 2nd floor consists of a bathroom, two bedrooms and an uncovered veranda. Access to the floors is achieved through an internal staircase.

Externally, the house enjoys a space of 24sqm and a yard of 12sqm. The property has an exclusive right of use of the roof top and the covered parking space no. 18 on the ground floor.

Sale can be effected through a SPA (Sale Purchase Agreement).

# Additional information

## Facilities

Parking, Covered

## Contact us



**Marinos Kineyirou**

✉ [marinosestates@spidernet.com.cy](mailto:marinosestates@spidernet.com.cy)